

TACT SWITCH

Technical data

- 1.Contact: Mechanical Contact
- 2.Rating: DC 12V 50mA
- 3.Travel: 0.25 ± 0.1m/m
- 4.Operating Force: 160+30gf
- 5.Contact Resistance: 50m Max
- 6.Life: 100.000 Cycles Min

A06-C

- 1.Contact: Mechanical Contact
- 2.Rating: DC 12V 50mA
- 3.Travel: 0.25 ± 0.1m/m
- 4.Operating Force: 160+30gf
- 5.Contact Resistance: 50m Max
- 6.Life:100.000 Cycles Min

MODELNO	Knob(H)	MODELNO	Knob(H)	MODELNO	Knob(H)
A06-A-4.3	4.3	A06-A-9	9.0	A06-C-4.3	3.15
A06-A-4.5	4.5	A06-A-9.5	9.5	A06-C-5	3.85
A06-A-4.8	4.8	A06-A-10	10	A06-C-6	4.85
A06-A-5	5.0	A06-A-11	11	A06-C-7	5.85
A06-A-5.5	5.5	A06-A-12	12	A06-C-8	6.85
A06-A-6	6.0	A06-A-12.5	12.5	A06-C-9.5	8.35
A06-A-6.8	6.8	A06-A-13	13	A06-C-11	9.85
A06-A-7	7.0	A06-A-15.3	15.3	A06-C-12	10.85
A06-A-7.5	7.5	A06-A-17	17	A06-C-13	11.85
A06-A-7.7	7.7	A06-A-20	20	A06-C-15.3	14.15
A06-A-8	8.0	A06-A21	21	A06-C-17	15.85

A07-HL=4.3,5,7.5,10,12,15,18,

- 1.Rating: 12VDC.50mA
- 2.Operating Force: 160+30gf
- 3.Travel:0.3 ± 0.15mm
- 4.Contact Resistance: 100M -2(Max) 100,000cycles
- 5.Operating Temperature: -25-70°C



A06-H

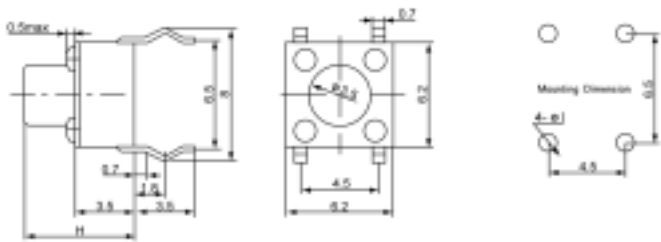

A06-H-A1

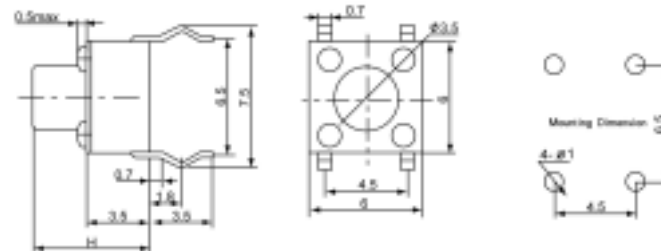

A06-H-A2

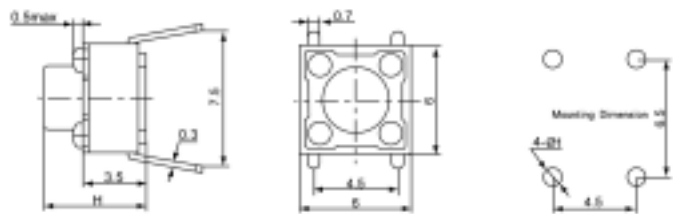

A06-E

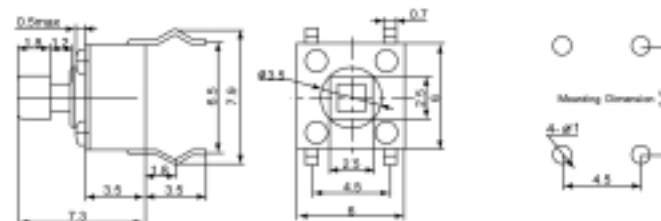



### TACT SWITCH



A06-H-B

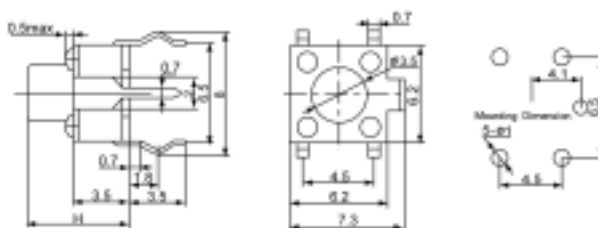

A06-H-C<sub>1</sub>

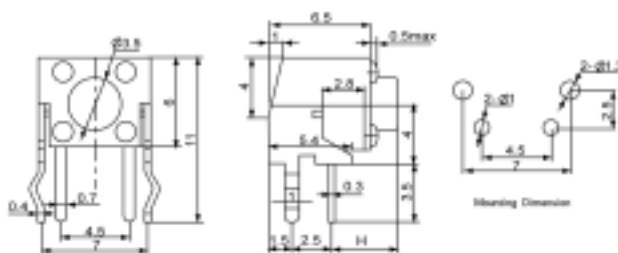

A06-H-T<sub>2</sub>

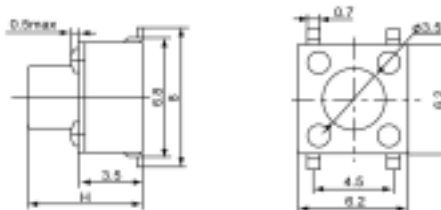

A06-H-T<sub>1</sub>

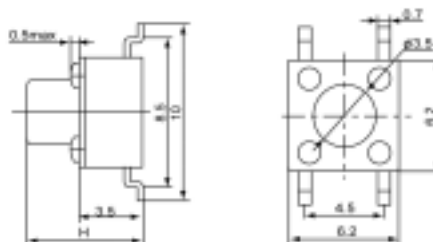

A06-H-T H=2.5,2.7,3.1,3.4

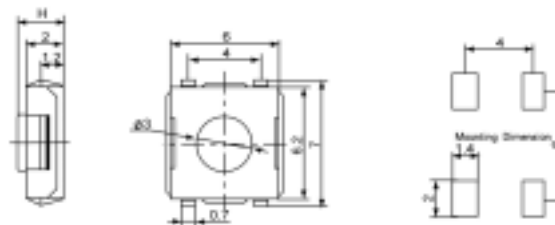

A06-T<sub>1</sub>

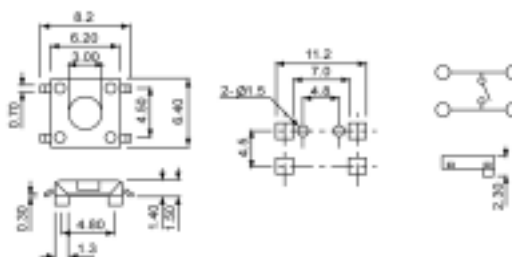

TACT SWITCH



5x5-T<sub>1</sub>

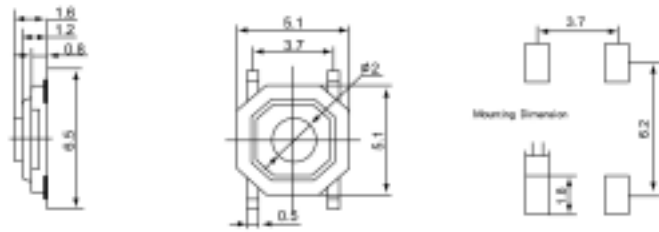

3x6-T3 H=4.3,5

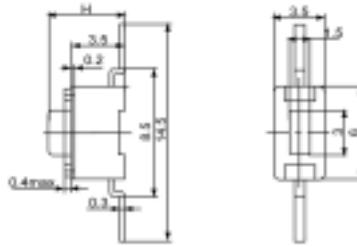

3x6xH H=4.35

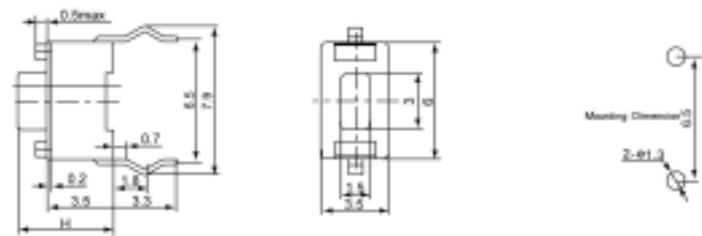

A07-H

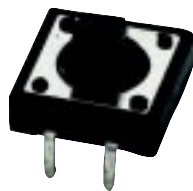
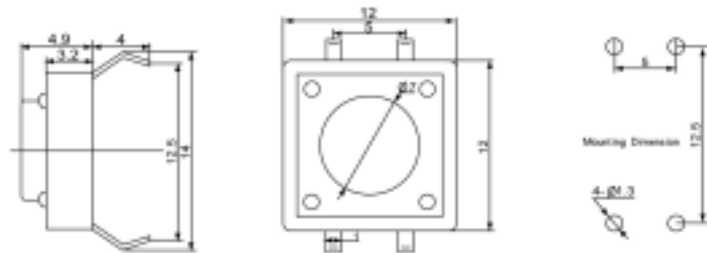

A07-02

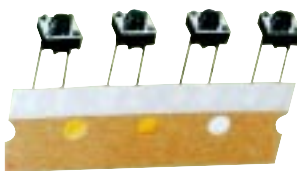
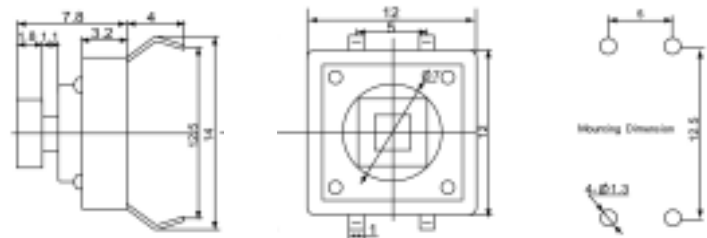

KFC-A06-D-1

